



NEW OFFICES @

ASPIRIA





A LIVE-WORK-PLAY DESTINATION

A TRANSFORMATIVE REBIRTH

PROPERTY HIGHLIGHTS

Concerts On The Water
Nature Trails / Bike Paths
Restaurants / Entertainment
App Based Engagement
Amazing Experiences
Walkable / Pedestrian-Focused

Mixed-Use Environments
Corporate Headquarter Destination
Unparalleled Natural Amenities
Smart Campus Technology
Community Events

LOCATION

20 mins from downtown KC
Close to I 435 with easy access to I 35 and I 635

SPACE

18 existing buildings
200+ acres - new dev roughly 60 acres
On-site management and property management

AMENITIES

Technology - Secure Fiber Network, Health and Safety, and Reliable Services

Security - Badge Access and Security Guards, 24/7 Security Cameras, Security Escort

Health and Wellness - Fitness Center and Sports Facilities

Green Space - Walking and Bike Trails, Beautiful Landscaping, and Water Features

DEMOGRAPHICS

High-end corporate housing developments

Significant number of advanced degrees

\$100k+ household incomes

Exterior Corporate Signage

Visible and easy to navigate

Executive housing nearby

SITE PLAN



OFFICES WITH LAKE VIEWS



ROOFTOP PATIOS WITH LAKE VIEWS



CONCERTS ON THE WATER



EXERCISE AND FITNESS



ACTIVE HOBBIES



BIKE SHARE / PATHS

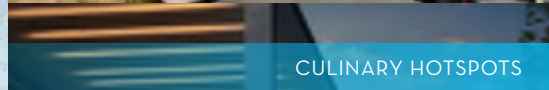

CULINARY HOTSPOTS



CONTEMPORARY OFFICE ENVIRONMENT

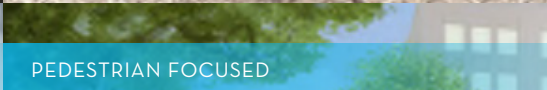

PEDESTRIAN FOCUSED

MAIN LEVEL



GARAGE LEVEL

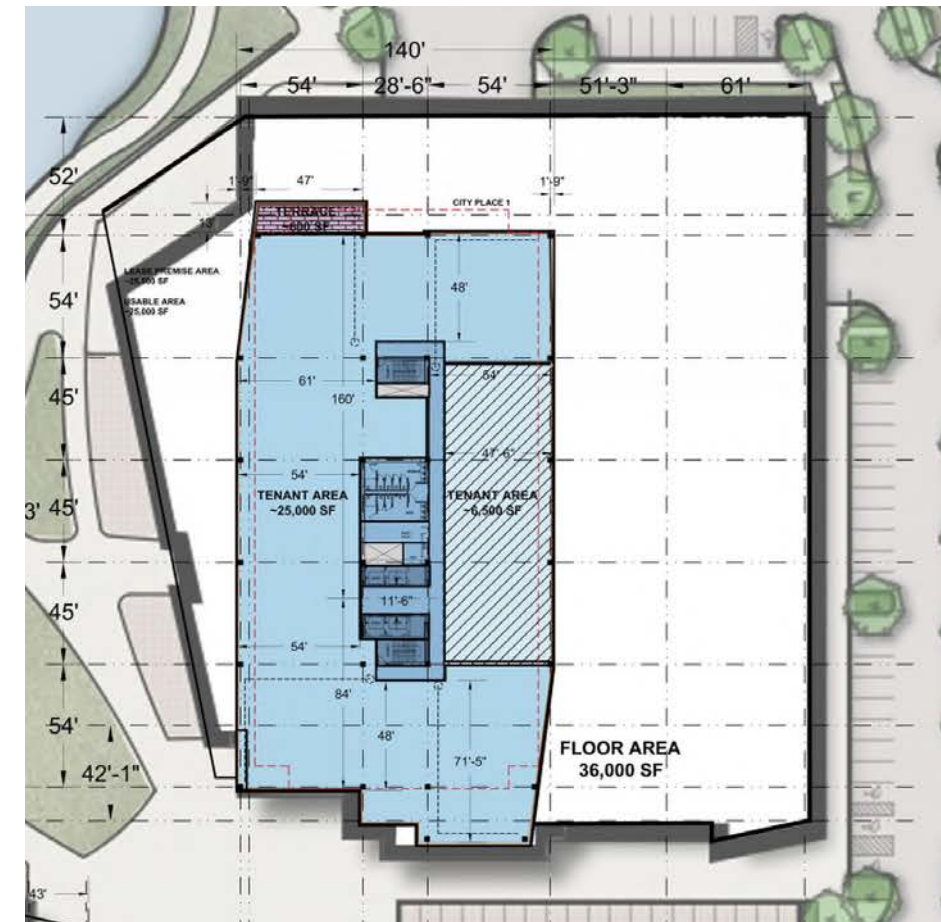
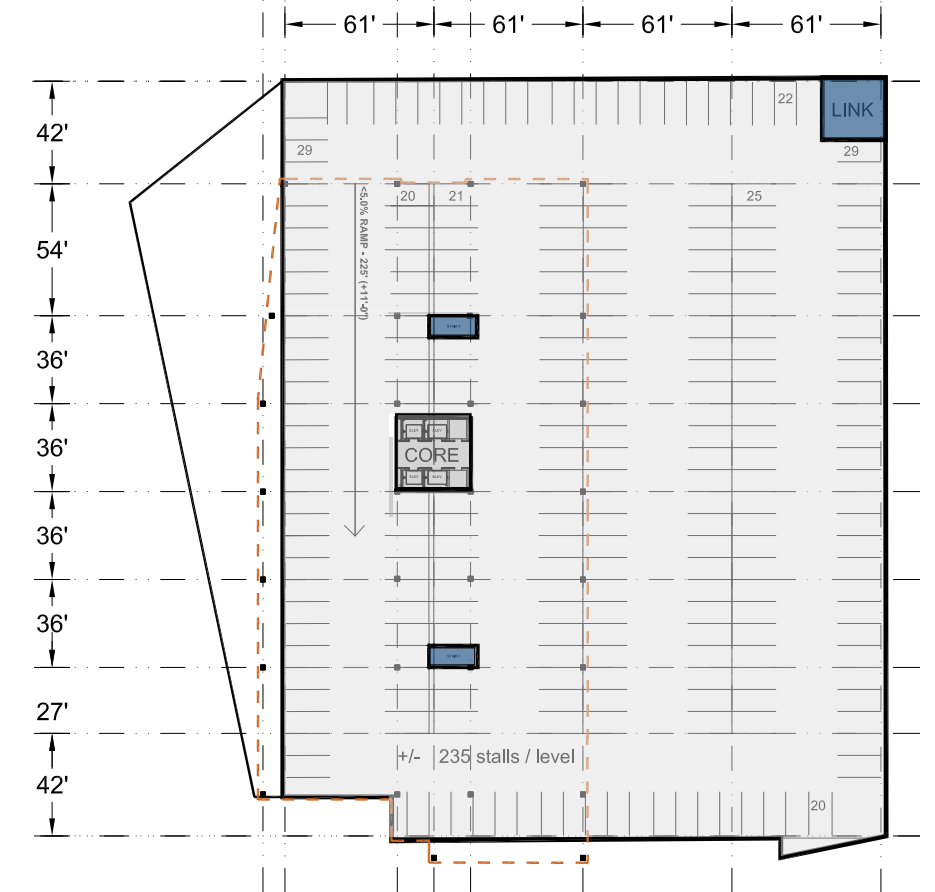

OFFICE LEVEL





ABOUT THE OWNERSHIP: OCCIDENTAL MANAGEMENT

WHERE IDEAS TAKE FLIGHT

Occidental Management specializes in commercial real estate development, leasing and property management within the retail, office and industrial segments. We specialize in high quality, live-work-play oriented spaces ideally located and rich in amenities.

Occidental Management is a vertically integrated commercial real estate company based in Wichita, Kansas. Established in 1997, Occidental Management has evolved into one of the leading real estate development and leasing companies in the Midwest. We own and operate assets in a variety of segments, including retail, office and industrial properties.



MISSION:

To create the best quality for the best value in the markets we serve for our customers, partners and team members



CORE VALUES:

Our professionalism, creativity and commitment to quality are hallmarks of the Occidental Management team. We put special focus on establishing strategic relationships within the community.





NEW OFFICES @
ASPIRIA

Leased By



MICHAEL MAYER, SIOR
Managing Principal
michael.mayer@cushwake.com
+1 816 412 0241

CONOR TWIBELL
Director
conor.twibell@cushwake.com
+1 816 412 0244

A Property Of



JOSH GOLDSMITH
Senior Director
josh.goldsmith@cushwake.com
+1 816 216 5673